

F/W Upgrade Method

To upgrade both Android and iOS in the same way

① Turn on power of Smart mobile phone and Smart Beam Laser

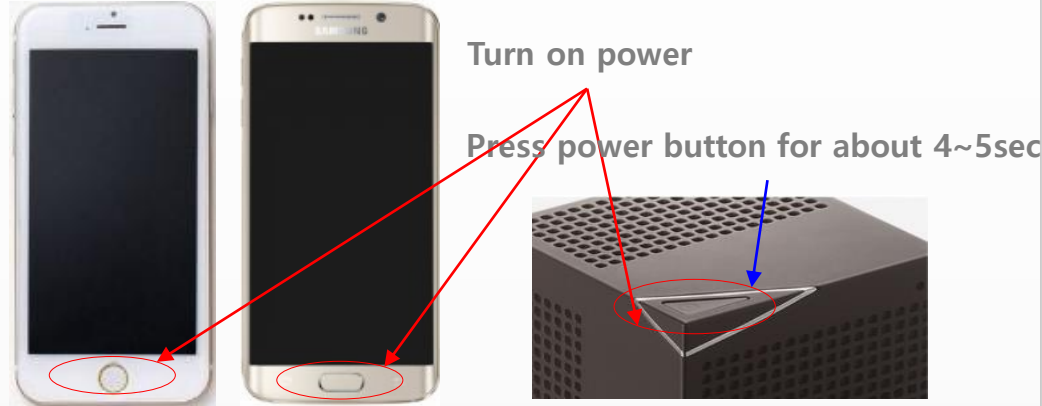

② In case of Miracast mode, please double click for mode switch (It should be DLNA mode)



③ Make sure that mode is DLNA mode



④ Select Wi-Fi of Smart Beam Laser in 'Setting'



Smart Beam Laser Device name

To upgrade both Android and iOS in the same way

⑤ Run web browser and input 192.168.49.1 on the address bar

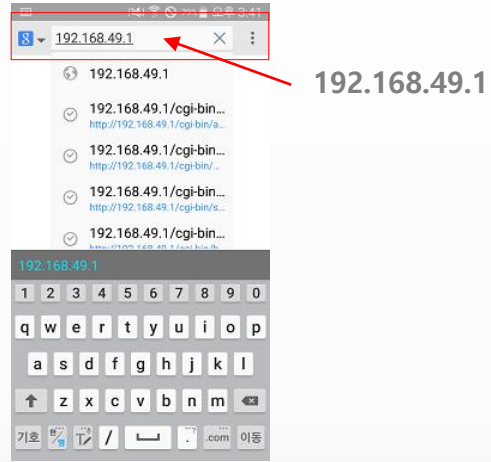

⑥ Select WiFi button



⑦ Search external AP(WiFi Network)

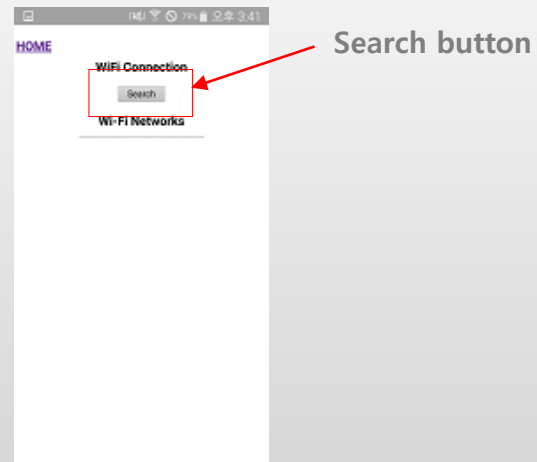

⑧ Select available AP on the WiFi Network List

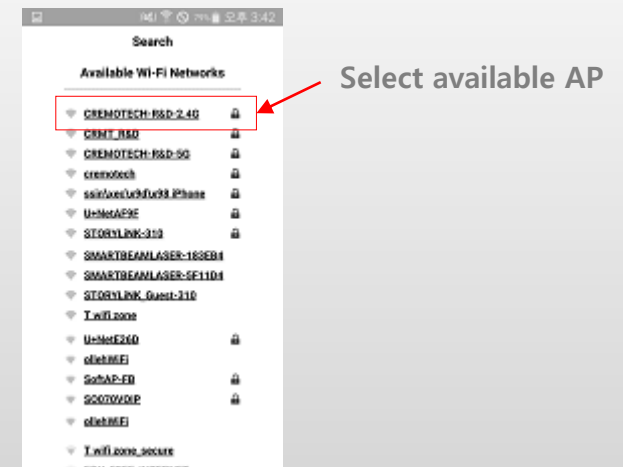

To upgrade both Android and iOS in the same way

⑨ Input PW and click "Connect" button



⑩ As you can see below, it will be displayed Connection image



⑪ Confirm "Internet Connected" text and SSID



⑫ Select F/W Upgrade button



To upgrade both Android and iOS in the same way

⑬ Click Connect text for F/W Upgrade

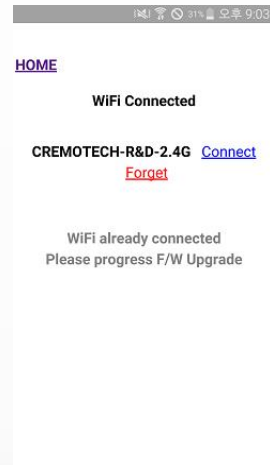

⑭ Download/upgrade will be automatically progressed

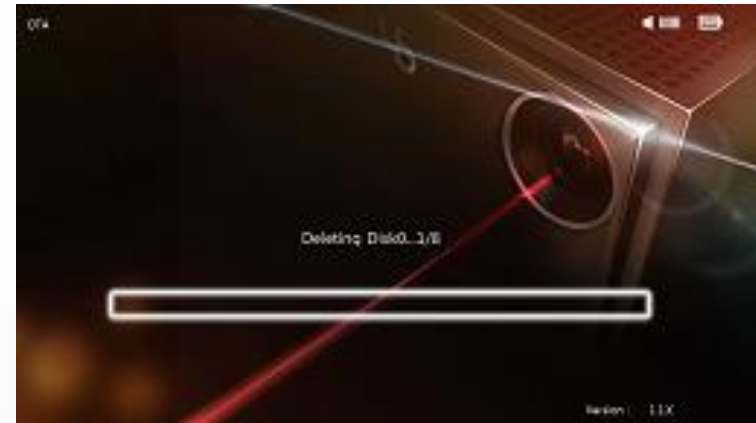

⑮ Displayed SK telecom logo after upgrade success and then it will be automatically rebooted

